

SISTEM DE DRENARE A APELOR DIN SPATELE CULEELOR
SYSTEM FOR DRAINAGE THE WATER FROM BEHIND THE ABUTMENTS

Sc.1:10

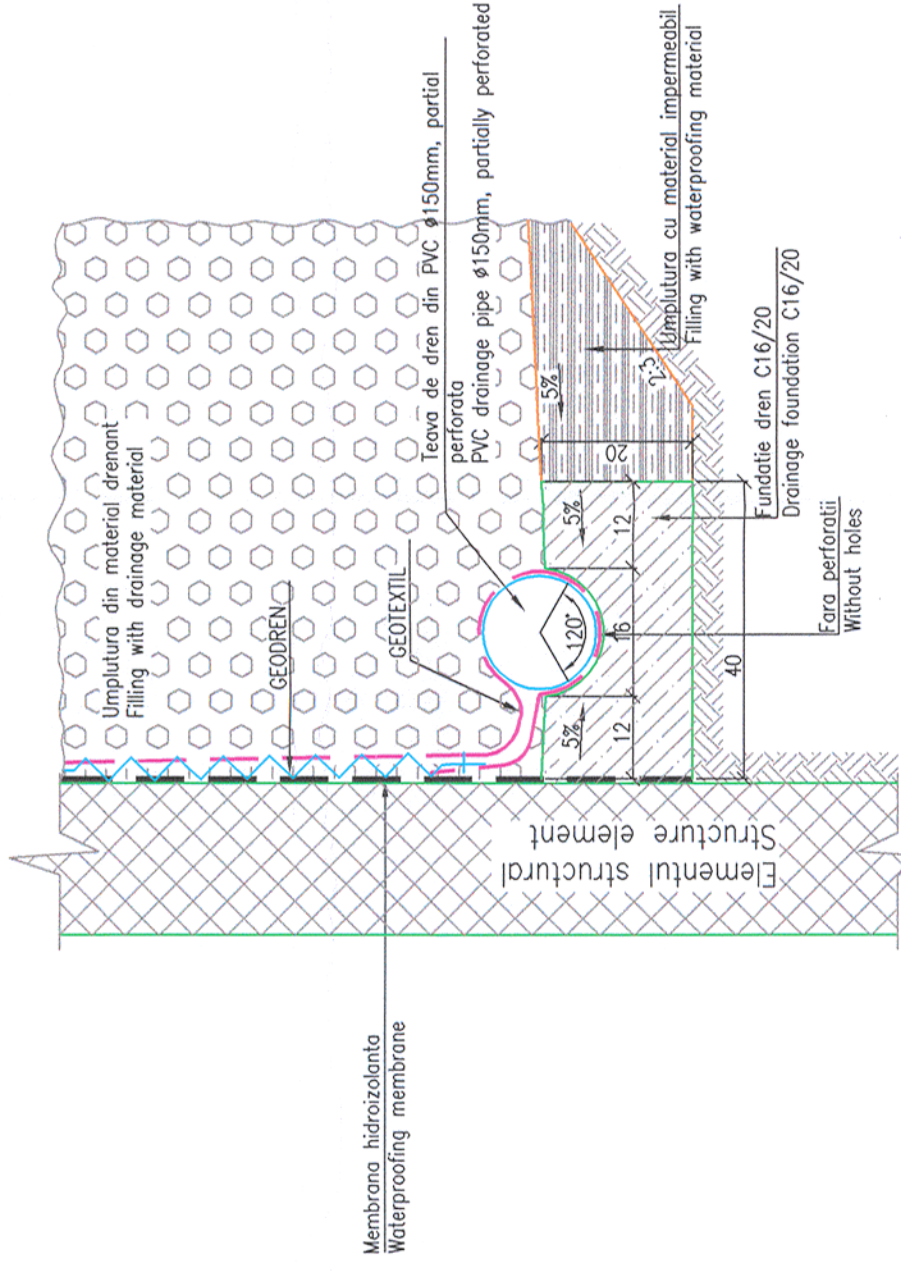

GEO-DREN:

Foie de Geocompozit format dintr-o retea cu rol de scurgere (fie sectiune alveolara, fie fire, bare etc) si un geotextil de filtrare.

Caracteristiciale fizico-mecanice:

- Rezistenta la compresie 400kN/m²
- Rezistenta la intindere 3kN/m²
- Permeabilitate la apa 0.062m/s
- Suprapunere min. 15 cm



GEO-DRAIN:

Geo-composite foil formed of a grid acting as leakage space (alveolar section, threads, bars, etc.) and a filtration geo-textile.

Physical-mechanical characteristics:

- Resistance to compression 400kN/m²
- Resistance to elongation 3kN/m²
- Waterproofing 0.062m/s
- Minimum overlapping 15 cm







LEGENDA BETOANELOR/CONCRETE LEGEND
conform NE 012-1:2007/SR EN 206-1

-  BETON C16/20 - Clasa de expunere X0+XF3, agregate Dmax 16.
-  DREN, BETON DE PANTA SI DE EGALIZARE
-  DRAINAGE, SLOPE AND LEAN CONCRETE

Prezentul plan anuleaza si inlocuieste versiunea anterioara
This plan cancels and replaces previous version

Nr. 07230



Verificator / Expert Checker / Expert	Semnatura Signature	Referat / Expozitia Report / Expertise
		
MINISTERUL TRANSPORTURILOR BENEFICIAR / BENEFICIARY :  COMPANIA NATIONALA DE CALI FERATE "CFR" SA		
PROIECTANT / DESIGNER:		
		
Aprobat Approved Verificat Checked	Sef de echipa Team leader Expert Cheie Key Expert	Data Date
Subcontractant / Subcontractor Aprobat Approved Proiectat Designed	C. Teodorescu R. Tudorascu 	01.2013 01.2013
Aprobat Approved Proiectat Designed	Adjunct Sef de echipa Deputy Team leader Inginer Engineer	01.2013 01.2013
"Reabilitarea liniei c.f. Frontiera - Curtici - Simeria, parte componentă a coridorului IV Pan - European pentru circulația trenurilor cu viteză maximă de 160 km/h" "Rehabilitation of the Railway Line Border - Curtici - Simeria, component Part of the IV Pan - European Corridor for the Trains Circulation with maximum speed of 160 km/h"		Project gi 35311.1 Faza / Phase: PTH+CS / TD+TS
Denumire desen / Drawing name: SISTEM DE DRENARE DRAINAGE SYSTEM		
Scara / Scale 1:10	Revizia / Revision 1 / 04.2013	Cod desen / Drawing Code PT.02.02.00.FO.20
		Nr / No 20